



The Secure Alternative



storm
Interface

AXS Secure Keypads
for access control

With rising crime rates and an increasing incidence of assaults on personnel, the need to control access to buildings or work areas has never been greater.

It is essential to provide free access to authorised personnel, whilst securing premises against those who are not. The high risk practice of issuing duplicate door keys is no longer acceptable or economically viable.

Keys (or cards) are regularly lost, stolen or copied. If a breach in security is suspected, locks must be changed and new keys (or cards) issued. This is not practical on a repeated or routine basis.



The fitting of a **STORM AXS Keypad** provides a secure, efficient and cost effective solution. Authorised personnel can be allocated a 'Personal Identification Number' (PIN) which, when entered into the keypad, triggers an electrically operated strike or lock. This permits instant access through a normally locked door or barrier. PIN codes can be regularly changed to maintain system security, or can be withdrawn at any time to discontinue an individual's access to the secured area.

Code holders can be given access to selected areas and debarred from others. For example; an office worker's PIN code can be programmed to allow access to an administration centre but prohibit access to a stores area; whereas the Store Manager's PIN code can be programmed to access both the administration centre and the stores area. PIN codes can be programmed to unlock a door and leave it unlocked (latched) until the code is re-entered. Alternatively they can be programmed to unlock the door for a pre-set time allowing just one person to enter before the door re-locks.



Robust, responsive keypad

technology, proven in military, industrial and public environments.

STORM AXS Keypads provide rapid and reliable access control in professional 'high-traffic' applications. Constructed to withstand hard use and



abuse the keypads can be fitted in exposed outdoor locations. Available in both 'general service' and 'vandal resistant'

specifications, complying with current and forthcoming mandatory standards, **STORM AXS Keypads** are ideal for use in all indoor and outdoor installations.



Secure and simple to install.

STORM AXS Keypads include sophisticated electronic controllers. These controllers, utilising the latest developments in microprocessor technology, are securely housed within the keypad casing. The keypads include high level protection against static



discharge damage. They can be selected to achieve direct, local control of door locking mechanisms (Strike Master) or to provide electronic communication with centralised alarm and access control systems (Code Master).

The **STORM AXS Strike Master** keypad includes an electronic sensor that detects any attempt to remove or tamper with the keypad.

This feature provides high level system security whilst maintaining the advantages of a self-contained, compact, 'one-box' installation.



storm
Interface

AXS Secure Keypads
for access control

A CHOICE OF ELECTRONIC INTERFACES

AXS Strike Master

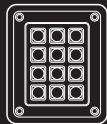

Secure, self-contained keypad and controller for electrically operated locks and strikes.

Authorised personnel can use their PIN code to open either one or two normally locked doors. Up to 50 different 4, 5 or 6 digit codes can be individually programmed. Each code can be set to trigger an electric lock or strike for a pre-set time (allowing just one person to access), or to 'latch' the door in an unlocked condition (requiring the code to be re-entered to 'unlock' or re-lock the door). If the Strike Master keypad is used to control a single door, the 'forced door alarm', 'anti-tamper alarm' and 'duress alarm' features can be enabled.

- Up to 50 user programmable PIN codes
- 4, 5 or 6 digit PIN codes
- Indexing permits the secure allocation and re-allocation of PIN codes
- One or two door control
- Anti-tamper alarm
- PIN code entered under duress alarm
- Forced door alarm
- Timed release or latched door option for each PIN code
- Fail (open) Fail (closed) option
- Timed lock out for repeated invalid code input
- Remote exit switch facility
- Hidden PIN code feature
- All weather resistant
- LED and audible tone status indication
- Requires 11 to 28V DC or 9 to 20V AC supply
- Quick and easy to install
- Three protection levels:
 - i) Anti-vandal keypad for exposed, unsupervised hostile, public locations
 - ii) Vandal resistant keypad for unsupervised, public, outdoor locations
 - iii) Robust keypad for outdoor/indoor location

AXS -COM

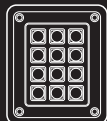

A Secure, self contained, two way voice communication system in 1 and 4 doorbell/callbutton versions

AXS Code Master

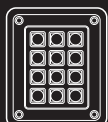

Converts codes entered via the keypad into industry standard (Weigand) data. Suitable for use as a replacement for (or in conjunction with) most standard card readers.

Intended for use with integrated access control / security systems, the keypad's electronic interface is user programmable for 26 or 32 bit (Weigand) data output.

- Selectable 'keypress' audible tone
- Selectable 'code accepted' audible tone
- All weather resistant
- LED status indication
- Requires 5V to 12V DC supply
- Quick and easy to install
- Three protection levels:
 - i) Anti-vandal keypad for exposed, unsupervised hostile, public locations
 - ii) Vandal resistant keypad for unsupervised, public, outdoor locations
 - iii) Robust keypad for outdoor/indoor location



The Secure Alternative

(Fixing hardware, sealing gaskets and comprehensive installation / operating instructions supplied)

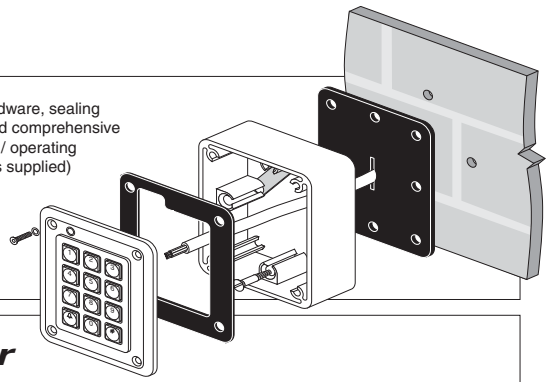

PRODUCT SPECIFICATIONS

AXS Strike Master

Dimensions: 19.00, 19.00, 63.50, 74.00, 99.50, 82.50, 93.00, 118.50, 30.00, 11.1, 10.50, 8, 2.5, 13.35 Overall

Features: Twin diode (2 colour) LED indicator, Four tamper-resistant stainless steel security screws

Wiring Diagram:

- 1. Return - Zero volts
- 2. Supply - Range 11 to 28 volts dc or 9 to 20 volts ac.
- 3. Door-1 Release Relay : Relay output (normally open)
- 4. Common - Relay common
- 5. Door-1 Release Relay : Relay output (normally closed)
- 6. Alarm/Door 2 Release Relay - Fully floating (volts free contact)
- 7. Alarm/Door 2 Release Relay - Fully floating (volts free contact)
- 8. Door/Call Bell - Open collector gate
- 9. Door Sensor - Used to monitor door 1 condition (open/closed)
- 10. Remote Switch - To open door 1 from within secure area

Other connections: Door Sensor, Remote/Exit Switch, Door Strike, Door/call Bell, Alarm Bell/Klaxon, Power Supply +V 0V

All dimensions in mm

AXS Code Master

Dimensions: 19.00, 19.00, 63.50, 74.00, 99.50, 82.50, 93.00, 118.50, 30.00, 11.1, 10.50, 8, 2.5, 13.35 Overall

Features: Twin diode (2 colour) LED indicator, Four tamper-resistant stainless steel security screws

Wiring Diagram:

- 1. Return - Zero volts
- 2. Supply - Range 6V to 12V DC
- 3. Weigand data 0
- 4. Weigand data 1
- 5. Indicator input (LED)

Other connections: System

Connect to access control / security system (refer to manufacturer's instructions for connection details).

All dimensions in mm

PRODUCT FEATURES	ANTI VANDAL KEYPAD	VANDAL RESISTANT KEYPAD	GENERAL SERVICE KEYPAD
Strike Master	DE1KT1	DEPLXT2	DE2KT1
Code Master	WE1KT1	WEPLXT2	WE2KT1
Key Life (cycles)	> 4 Million	> 4 Million	> 4 Million
Service Temp (Dry)	-20°C to +70°C	-20°C to +70°C	-20°C to +70°C
Keypad Material	Chromed Zinc	Super Impact Polymer	Super Impact Polymer
Keypad Colour	Silver	Black	Mid Grey
Keytop Material	Chromed Zinc	Chromed Zinc	Super Impact Polymer
Keytop Colour	Silver	Silver	Light Grey
Keytop Legends	Engraved	Engraved	Laser Marked
Legend Colour	Black	Black	Dark Grey
Contact Materials	Carbon / Gold	Carbon / Gold	Carbon / Gold
Weather Sealed	IP65	IP65	IP65
Resistance to Static Discharge	> 12.5 KV	> 12.5 KV	> 12.5 KV

All **STORM AXS Keypads** incorporate the proven **STORM** switching technology ensuring rapid, reliable and responsive data entry. Specified to survive in different service environments, ranging from exposed, unsupervised public environments to general service / indoor installations. Keypads in the **STORM AXS** range are dimensionally and electrically interchangeable. This allows users, entering codes at all outdoor or indoor access points, to establish and maintain familiarity with the keypad features.

Whilst every effort is made to ensure details are correct at time of print, specifications are subject to change without notice.



AXS-LIT-01 1SS.3



FM 39602



Storm is a trademark of Keymat Technology Ltd
Storm Interface is a trading name of Keymat Technology Ltd
Storm Interface products include technology protected by international patents and design registration. All rights reserved.