

EACH ASSEMBLY SUPPLIED WITH THREE  
COPPER PLATED STEEL MOUNTING CLIPS  
DESIGNED TO AFFIX TO 0.3125",  
0.375" & 0.500" DIAMETER PIPES.  
(0.3125" CLIP SUPPLIED PRE-INSTALLED  
ON PROBE HOUSING)

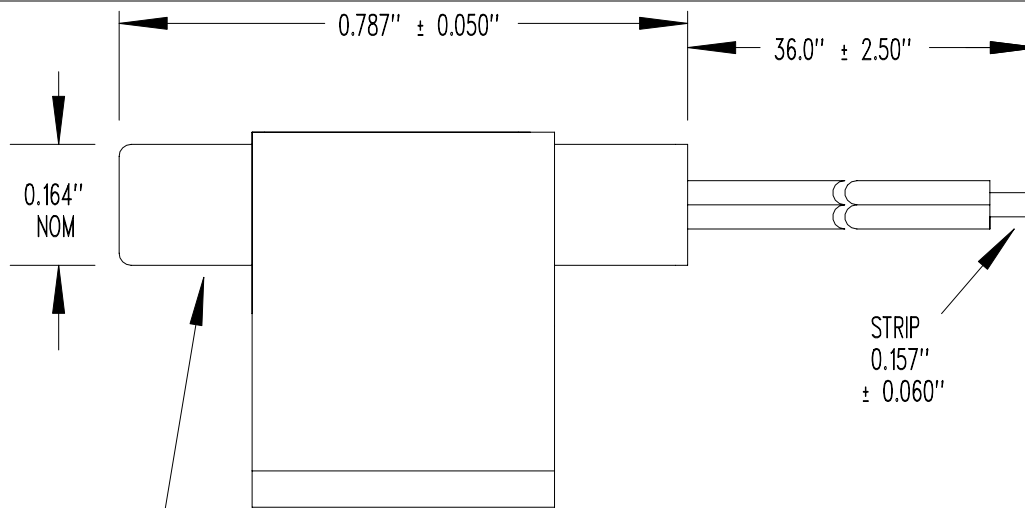
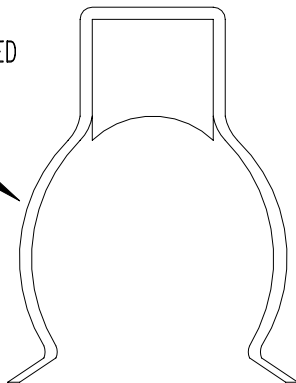

THERMISTOR ELEMENT POTTED  
IN COPPER PROBE HOUSING

RESISTANCE @ +25°C = 10,000 Ω ± 1%  
RESISTANCE/TEMPERATURE CURVE = "J"  
TEMPERATURE COEFFICIENT @ +25°C = -4.4%/°C NOMINAL  
BETA "β" (0 TO +50°C) = 3,892°K NOMINAL  
MAXIMUM TEMPERATURE RATING = +105°C

LEAD WIRE: 24 AWG, STRANDED CONDUCTOR,  
TWO CONDUCTOR, PVC INSULATED ZIPCORD

MOISTURE RESISTANT PROBE ASSEMBLY

SEE MANUFACTURING SPECIFICATION (LAYER 1)

"A"	PROBE DID NOT HAVE A CLIP INSTALLED	09/11/07	DD
NONE	RELEASE TO PRODUCTION	04/16/07	DD
REV	REVISION RECORD	DATE	APP

SCALE	NONE	<b>U.S. SENSOR CORP.</b> 1832 W. COLL INS AVE. ORANGE, CA . 92867 714-639-1000 www.ussensor.com
DRAWN BY	DAN DANKERT	
DATE	08/29/06	
REV.	"A"	
LAYER	0 OF 2	
		PIPE TEMPERATURE SENSOR
		P/N USP7766